

## IEC- Normmotoren Masse 2800 um

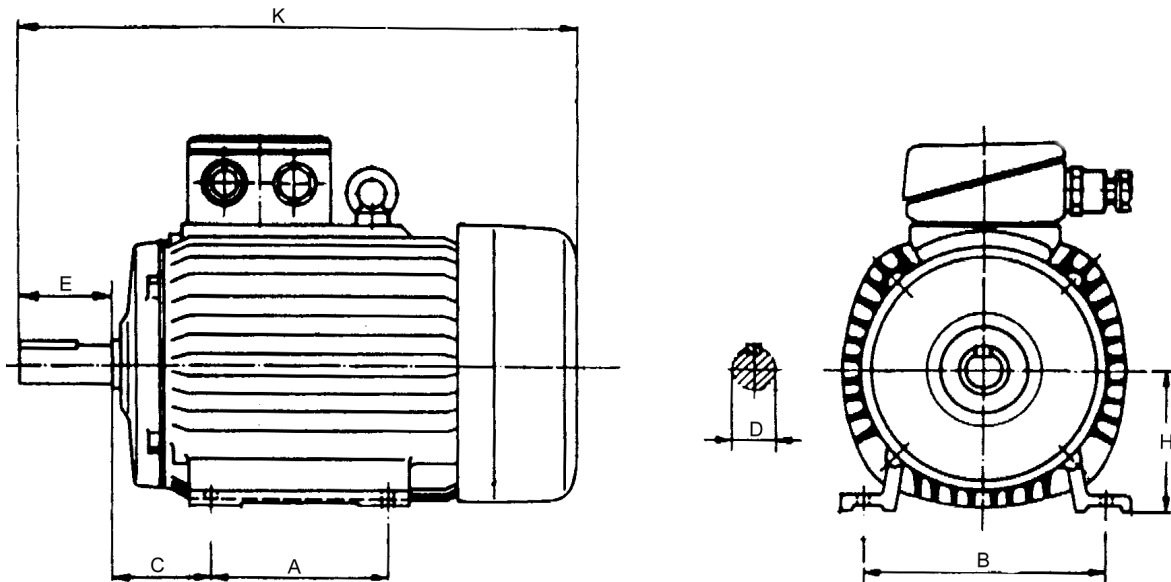

Mass "H" = Wellenmitte bis unterkant Fuss in mm entspricht der IEC Baugrösse (Typ)

IEC Typ	KG ca	KW	A in mm	B in mm	C in mm	D in mm	E in mm	K in mm
160 MA2	110	11	210	254	108	42	110	930
160 MB2	130	15	210	254	108	42	110	630
160 L2	165	18.5	210	254	108	42	110	674
180 M2	175	22	241	279	121	48	110	705
180 LB2	230	30	241	279	121	48	110	705
200 LA2	265	30	305	318	133	55	110	810
200 LB2	315	37	305	318	133	55	110	810
225 M2	345	45	311	356	149	60	110	855
250 M2	425	55	349	406	168	65	140	990
280 S2	575	75	368	457	190	75	140	1040
280 M2	620	90	419	457	190	75	140	1090
315 S2	715	110	406	508	216	80	140	1180
315 MA2	750	132	457	508	216	80	140	1180
315 MB2	800	160	457	508	216	80	140	1180